

# SERVICE BULLETIN

## AA-SB-32-003

### Installation of Alternate Steering Locking Rod Assembly

#### **1. Planning Information**

##### **1.1 EFFECTIVITY**

HR200 Series Aircraft S/N 001 to 378  
R2000 Series Aircraft S/N 001 to 378

##### **1.2 CONCURRENT REQUIREMENTS**

NIL

##### **1.3 REASON**

The part number of the Steering Locking Rod Assembly has changed for current production aircraft and there is no longer production of the original APEX part number.

##### **1.4 DESCRIPTION**

Allow the installation of new Alpha Aviation manufactured Steering locking rod on legacy APEX manufactured Robin aircraft.

##### **1.5 COMPLIANCE**

At operators option

##### **1.6 APPROVAL**

By delegated authority (Alpha Aviation Concept Ltd, DO75992) COA AA/60/1144

##### **1.7 WEIGHT AND BALANCE**

No Change

##### **1.8 REFERENCES**

APEX R2000 Service Manual S/N 001 to 378  
APEX HR200 Service Manual S/N 001 to 378  
HR200 & R2000 Illustrated Parts Catalogue

##### **1.9 OTHER PUBLICATIONS AFFECTED**

NIL

#### **2. Material Information**

##### **2.1 MATERIALS IDENTIFICATION**

<u>Part Number</u>	<u>Description</u>	<u>Quantity</u>
60-32-025-001	Steering Lock Rod Assembly	1
60-32-193-001	Guide Detail: Control Rod	1
MS21044N5	Nut - Nyloc	1
AN960-516	Washer	1
MS35335-34	Lock Washer	1
AN315-5	Nut - Plain	1

# SERVICE BULLETIN

## AA-SB-32-003

### Installation of Alternate Steering Locking Rod Assembly

#### **2.2 CONSUMABLES**

NIL

#### **2.3 PUBLICATIONS AFFECTED**

There are no changes required to current maintenance publications.

#### **2.4 SPECIAL TOOLING**

NIL

### **3. Accomplishment Instructions**

With reference to the aircraft Service Manual Section 6 & Figure 1 below.

#### **3.1 REMOVAL**

- (a) Remove the steering lock rod nuts and washers (SM Figure 6-1 Items 22 & 25) and remove the steering lock rod from the lock mechanism.
- (b) Remove the steering rod guide (SM Figure 6-1 Item 26) by removing items 27 – 29.
- (c) Retain the hardware removed in (b) for installation of new guide.

#### **3.2 INSTALLATION**

- (a) Insert guide (P/N 60-32-193-001 - Item 26) into the steering lock mechanism and reinstall hardware from 3.1(b) above.
- (b) Install the new steering lock rod (P/N 60-32-025-001 – Item 21) through the guide and install hardware supplied. Correct order is, install AN315-5 Nut and MS35335-34 Washer, fit to mount, install AN960-516 washer and MS21044N5 Nut.
- (c) Orientate the locking rod as per SM Figure 6-1. Tighten nuts then adjust as per SM Section 6.3.8.2.

## SERVICE BULLETIN

### AA-SB-32-003

#### Installation of Alternate Steering Locking Rod Assembly

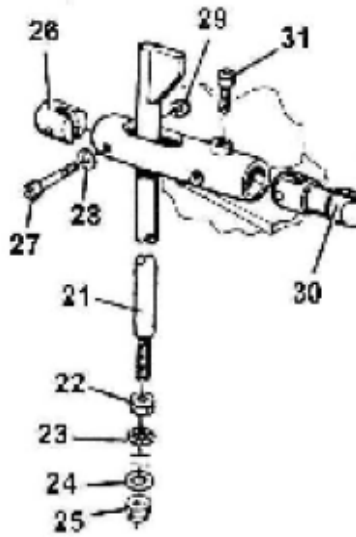

**Figure 1 : Exploded View of the Steering Lock Mechanism**

Item No.	Description
21	Steering Lock Rod Assembly
26	Guide – Control Rod
27-29	Guide installation Hardware
22-25	Steering Lock Rod Hardware

#### Contact Information:



Hamilton Airport  
RD 2  
Hamilton 2021  
NEW ZEALAND

**Web: [www.alphaaviation.co.nz](http://www.alphaaviation.co.nz)**